

VIVREAU FILL 200

COUNTERTOP AND FREESTANDING



INSTALLATION REQUIREMENTS

I. Installation requirements

- Do not install near direct or indirect heat sources (e.g. ovens, dishwashers, etc.). Ensure that hoses and cables do not contact heat sources.
- Place on a level surface resistant to liquids and heat that can bear the weight.
- Do not install at locations where there is a possibility of sprayed water or jets of water.
- Do not place any objects on the water dispenser.
- Make sure the environment condition is not explosive, corrosive or abrasive. Keep away from flammable objects.
- Avoid agitations and vibrations.
- The water dispenser is not suited for outdoor use.
- The ambient temperature should not exceed 32 °C / 89.6 °F.

1 Water connection:

A corresponding and functioning drinking water connection must be in the vicinity (to be provided by operator):

- 3/4" male angle valve or 3/4" male isolation valve terminated in a vertical position, preferably in stainless steel with shut-off valve in the cabinet underneath. The valve may also be made of chrome, plastic or brass in accordance with local legal requirements.
- For best performance and hygiene it should be located not more than 2 m left or right of the system. Do not exceed 6 m.
- Min. water supply flow pressure: 4 bar / 0.4 MPa (at 2 l/min waterflow).
- Connect only to drinking water lines that supply drinking water quality in accordance with the drinking water regulations at the location of use.
- Do not use in combination with a decarbonating filter or with pH-reducing systems (e.g. RO-system). Critical pH-value is < 6.5 pH.
- Install the provided water pressure regulator including a controllable backflow preventer. Thus, a backflow or back siphonage of water into the water supply network according to DIN EN 1717 is prevented and the water dispenser protected.

2 Electrical connection:

UK: 1 grounded switch socket 230 V / 10 A
Europe & Australia:
1 grounded switch socket 230 V / 13 A
in base cupboard unit at high level, max. 3 m left or right of the system. If needed, an extension cable has to be provided by the operator.

3 Waste water connection (optional):

Waste connection, trapped stand to facilitate a 1/2" flexible pipe (to be provided by operator).
Max. 2 m left or right of the system.

4 CO₂: Foodgrade CO₂ bottle type E290 is to be provided by the operator.

The spatial volume of the installation room must be known. The max. permissible size of the CO₂ bottle is calculated from this. Contact customer service if in doubt about the CO₂ bottle size. The CO₂ bottle must be placed as far as possible from any heat sources.

II. Preparations

Preparation of the furniture for installation.
All dimensions in mm.

Ventilation requirements:

The water dispenser must be installed in such a manner that there is sufficient ventilation. Never cover or block ventilation slits and cooling fins. Insufficient ventilation will lead to performance decrease.

Space required for service and maintenance work: 500 mm from left and right side of the dispenser.

Base cabinet requirements:

To ensure a stable installation the base cabinet must either be fixed to the wall using the wall mounting piece, or it must be installed with dedicated base cabinet base plate (recommended).

Top view

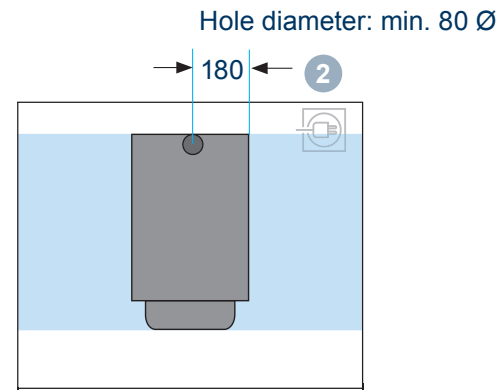

Front view

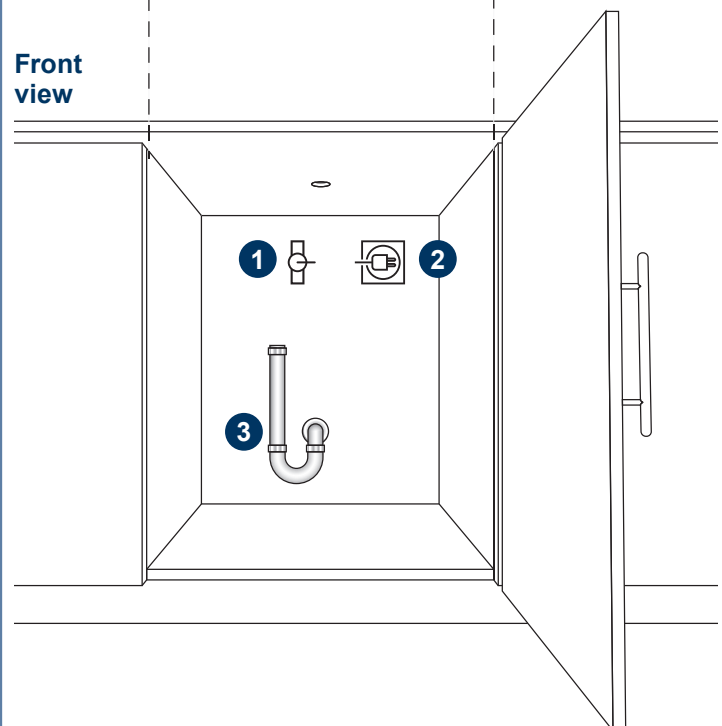

III. Arrangement

All dimensions in mm.

- a. VIVREAU Fill
- b. CO₂ bottle
- c. CO₂ pressure regulator
- d. Filter: Clarity Taste 100
- e. Optional: Waste water container
- f. Base cabinet optional
- g. Base cabinet base plate

Front view

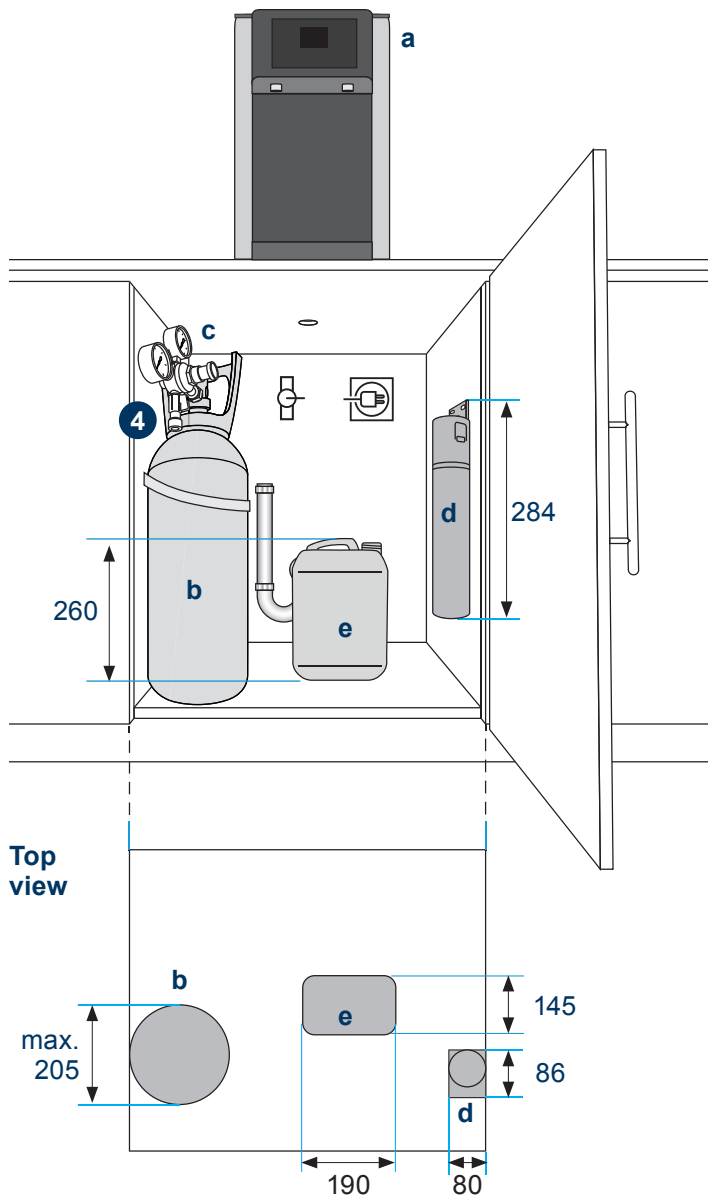

VI. Measurement

All dimensions in mm.

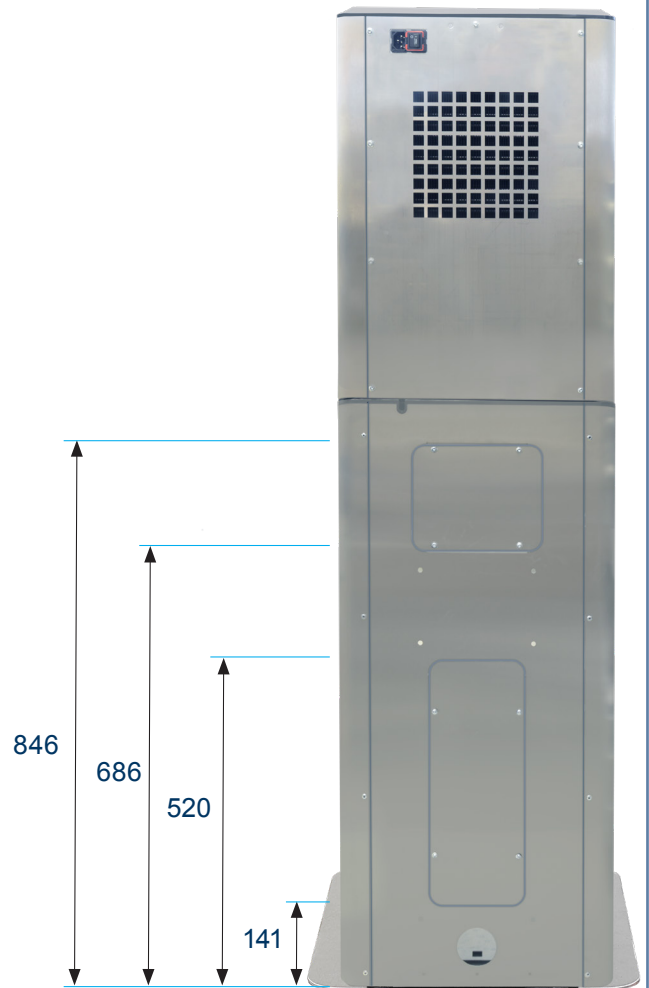
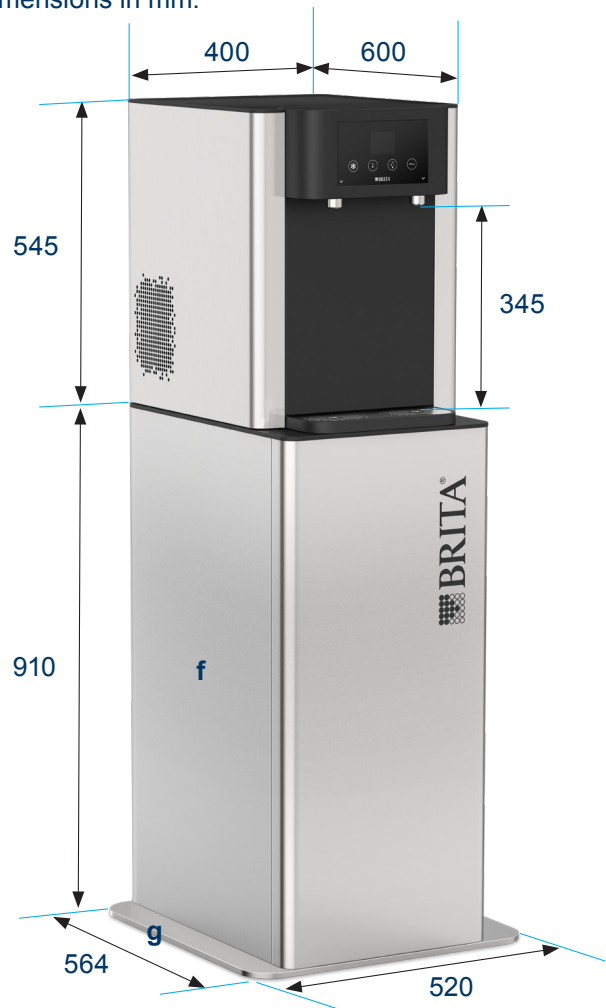

VI. Technical data

		VIVREAU Fill CT
Cooling capacity (l/h)		120
Minimum distance to kitchen upper cabinet (mm)		200
Dimensions Countertop (W x H x D mm)		400 x 545 x 565
Dimensions Floorstanding with Baseplate (W x H x D mm)		520 x 1454 x 564
Dispensing height (mm)		345
Weight Countertop (kg)		42
Weight Base cabinet (kg)		25
Max. flow rate (l/min)		2
Drip tray		Part of the appliance, movable
Water types		Unchilled, chilled still, semi sparkling, sparkling
Hygiene configuration		ThermalGate™
Waste water connection		Waste water pipe or waste water container (optional)
Voltage (V)		230
Frequency (Hz)		50
Max. current (A)		2.3
Max. power consumption (W)		529
Min. fuse (A)		10
Protection class		I
CO ₂ operating pressure (MPa)		0.4
Max. inlet water pressure (MPa)		0.6
System operating inlet water pressure (MPa / psi)		0.25 - 0.4 / 36.3 - 58
Inlet water temperature (°C)		5 - 25
Location temperature range (°C)		16-32
Max. relative humidity (%)		60 %
Noise emission dispensing / cooling (dbA)		63 / 42
Refrigerant	Type	R290
	Charge (g)	65
Max height above sea level (m)		<2000

BRITA GmbH
Heinrich-Hertz-Str. 4
65232 Taunusstein
Germany

www.brita.net

BRITA Vivreau Ltd
1st Floor
Beaufort House
Cricket Field Road
Uxbridge UB8 1QG
United Kingdom
www.vivreau.com